



*Introduction to  
NJCU @ Fort Monmouth  
Dr. Michael Edmondson*

# N JCU Has A Long History in Monmouth County

NJ Coastal  
Communiversities  
2004-2016

Brookdale  
University  
Partnerships  
2016-Present

NJCU @  
Fort Monmouth  
2021-

## 5 Things to Know About a Communiversities Degree

Brookdale's Communiversities is an educational bargain for students looking for a four-year degree and even a master's.

By Shannon K. Winning, Neighbor  
Feb 2, 2012 8:17 pm ET | Updated Feb 6, 2012 3:14 pm ET

<https://patch.com/new-jersey/middletown-nj/5-things-to-know-before-you-pay-for-college>



NJCU was one of several four-year institutions as part of the Brookdale Communiversities launched years ago where we could only offer limited programs and work with Brookdale students.



# Overall Fall 2020 Down; Fitch and Moody's Negative Outlook for Higher Education

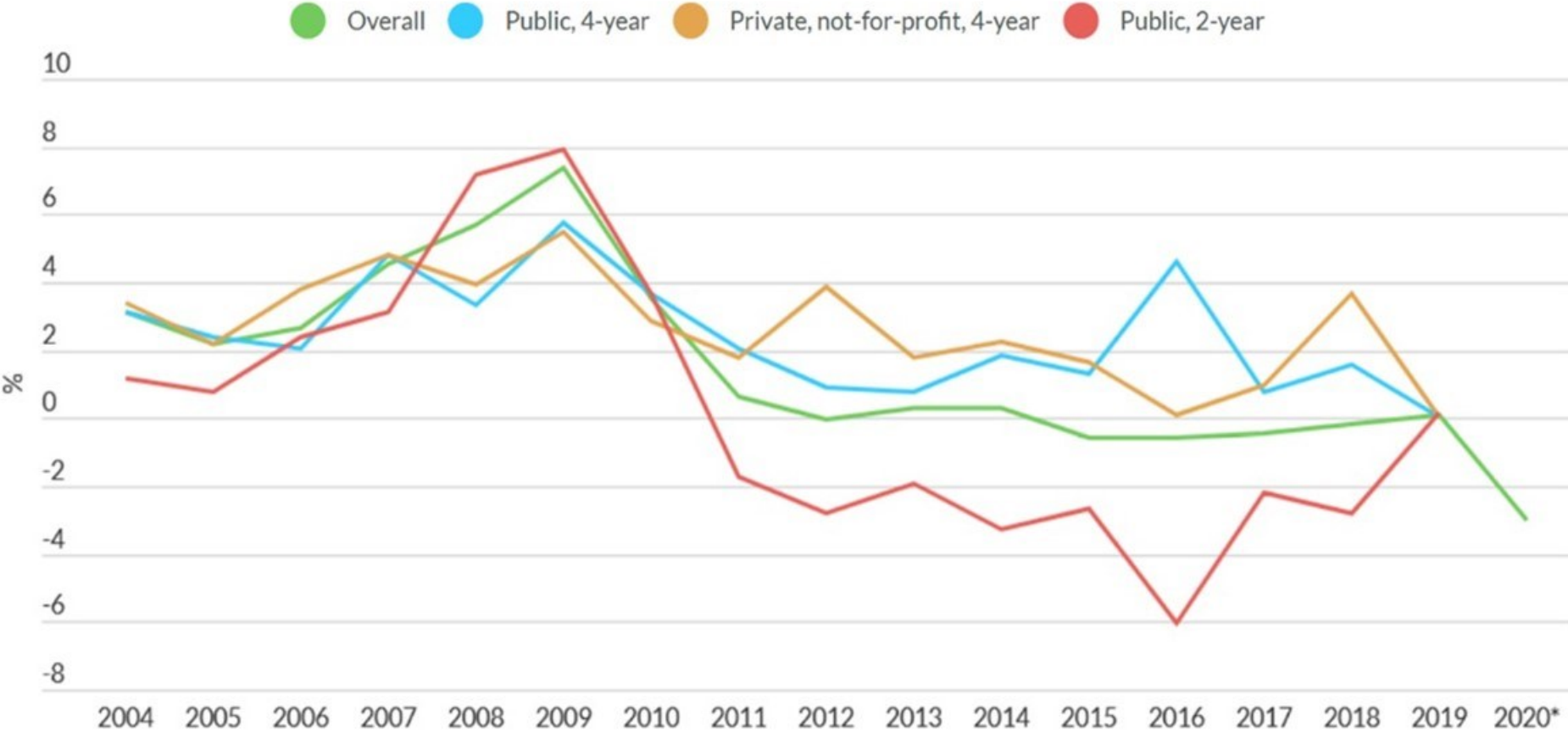

\*preliminary.

Source: Fitch Ratings, National Student Clearinghouse Center.

# Undergraduates In NJ Declined By 32,290 While Graduate Students Declined By 1,008 Between 2009-2019

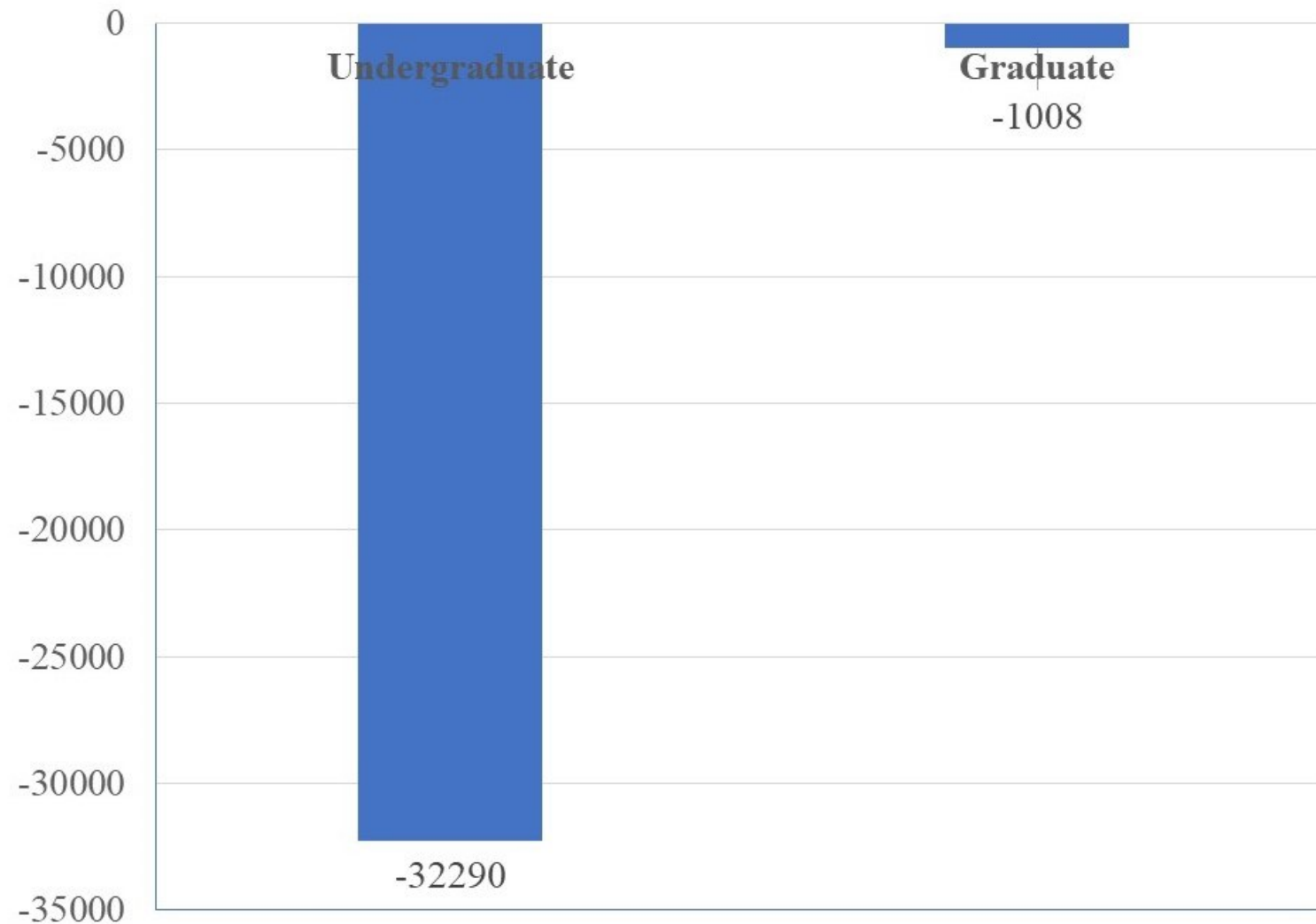

## Notes:

- Fall 2020 not included
- Rutgers not included
- Rowan added medical school fall 2012

# The Top 20 Institutions In Total Number of Full/Part Time Undergraduate & Graduate Students, 2019

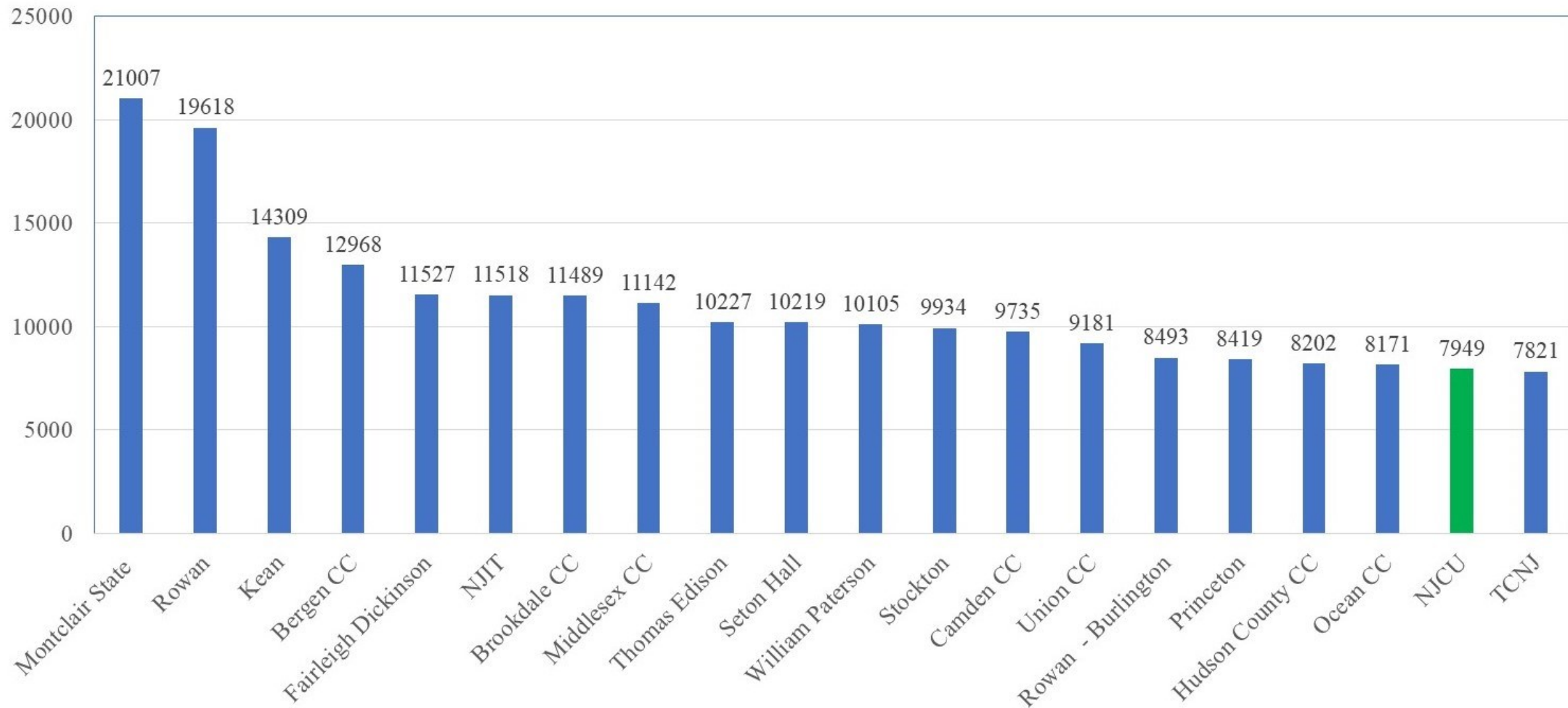

# 19 Institutions Experienced Positive Enrollment Growth (Undergraduate & Graduate Combined) Between 2009-2019

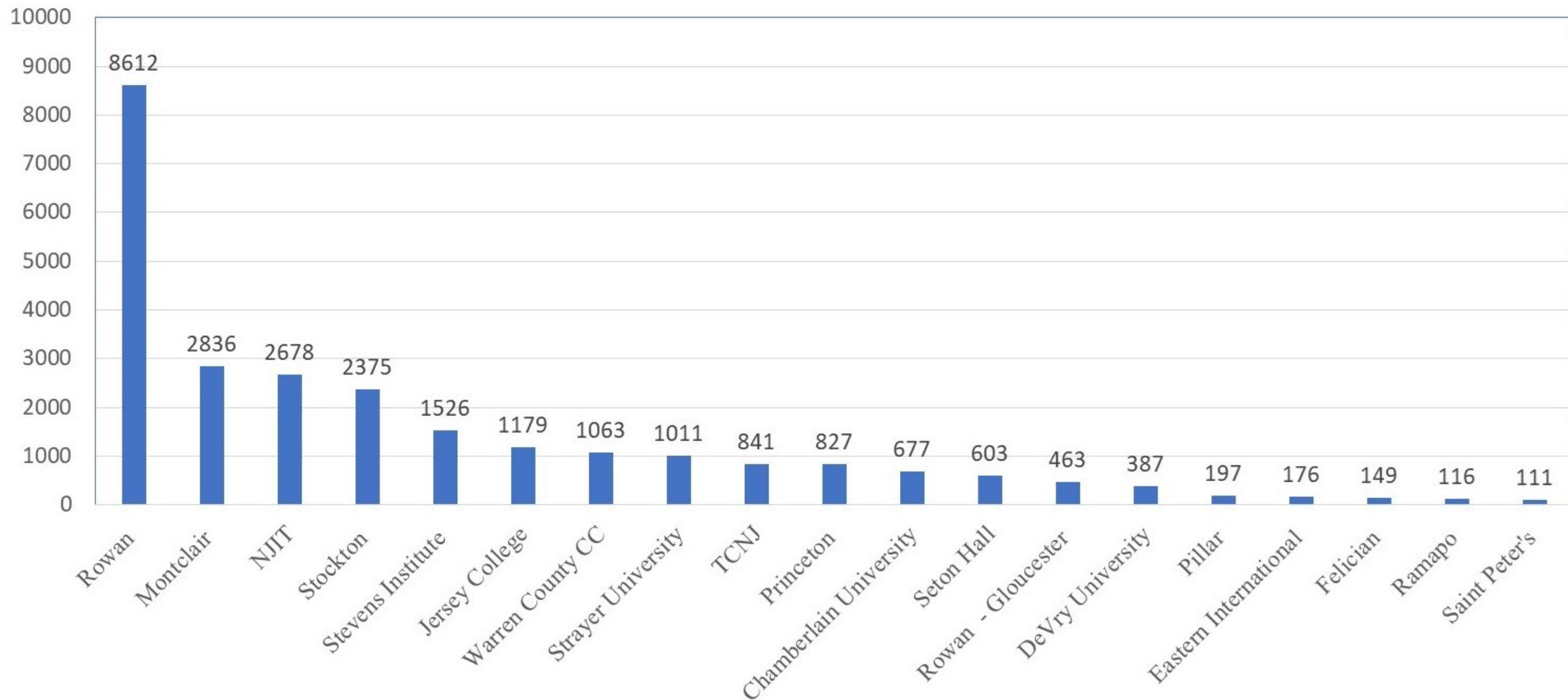

# 33 Institutions Experienced Negative Enrollment (Undergraduate & Graduate Combined) Between 2009-2019

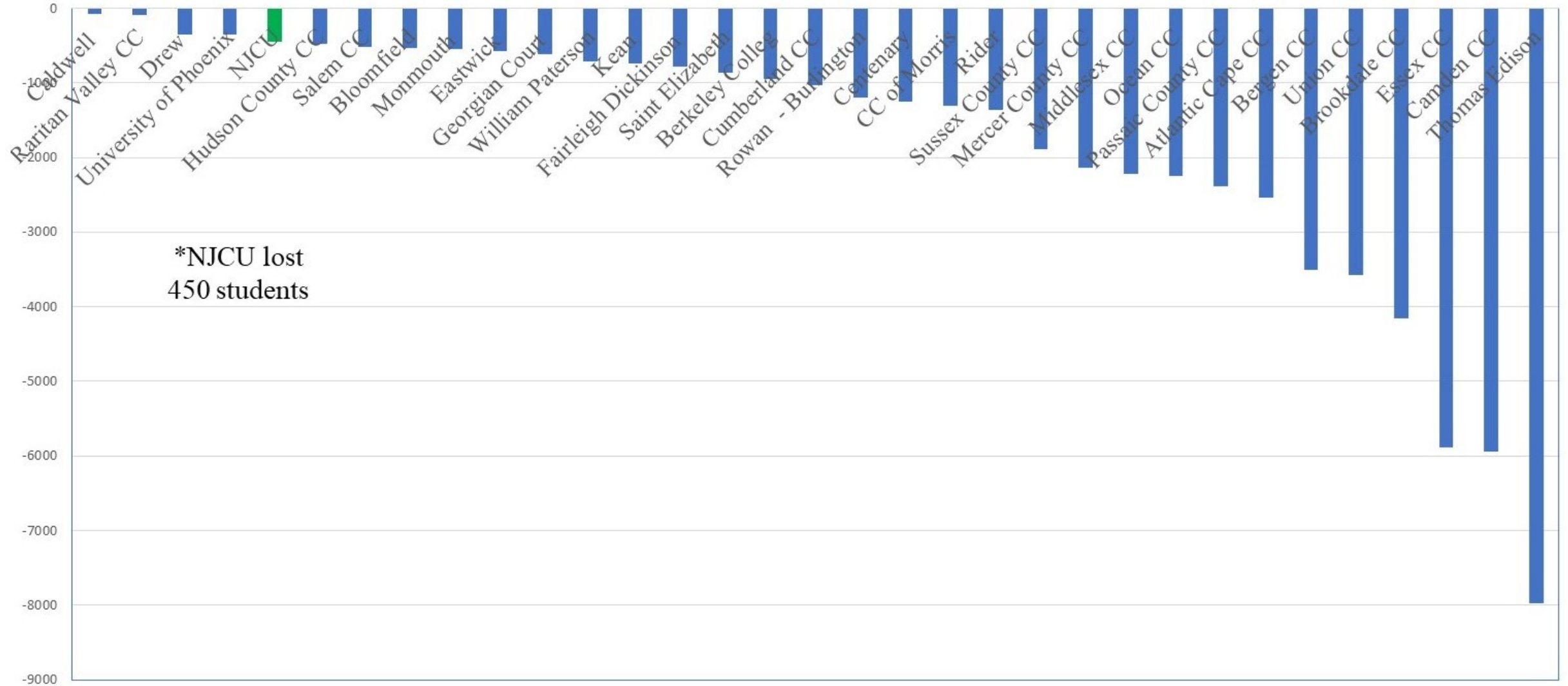

# At The Graduate Level, 13 Institutions Increased Enrollment While 15 Had A Decrease Between 2009-2019

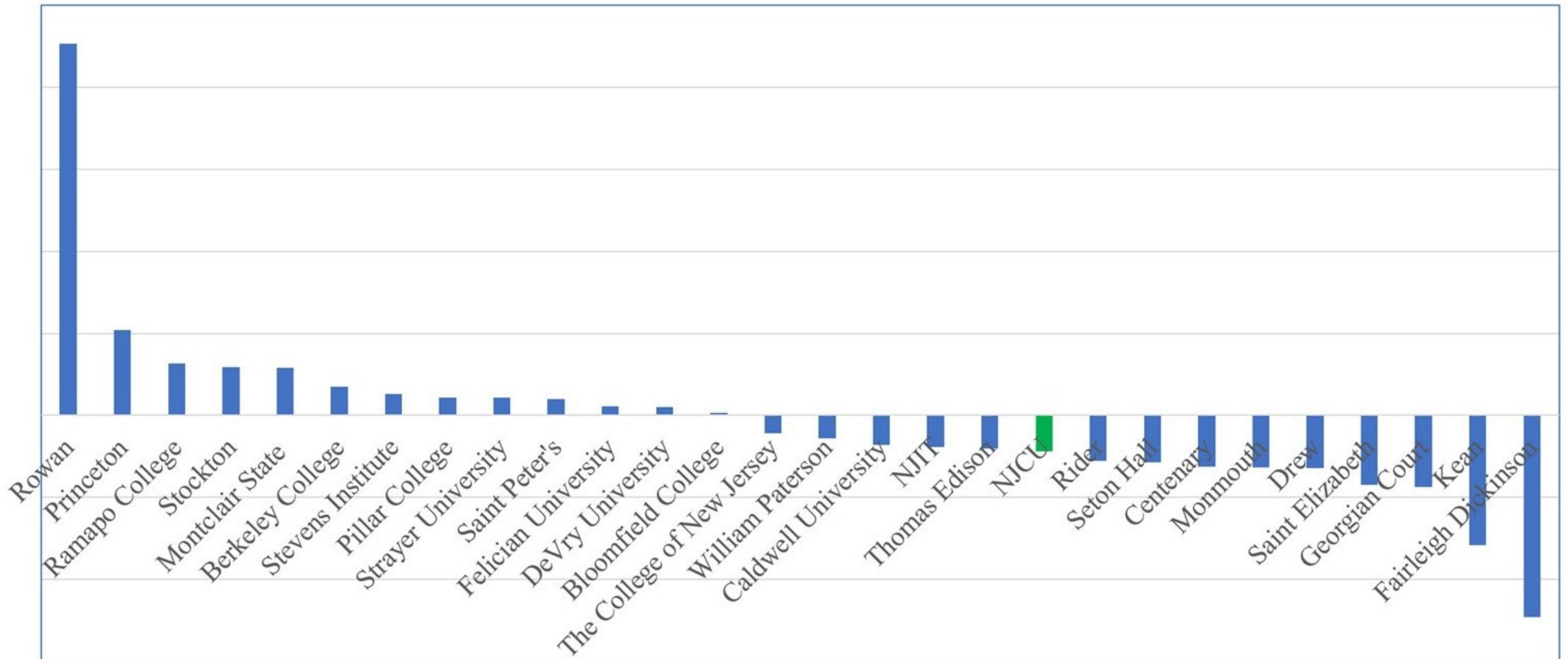



# NJ Population Projections by Race, 2010-2030

	2010	2020	2030
White	74.5%	70.7%	67.3%
Black	14.6%	14.5%	14.4%
Asian	8.5%	11.1%	13.3%
Other Races	0.7%	1.1%	1.6%
2+ Races	1.8%	2.6%	3.5%
<i>Hispanic</i>	17.7%	22.2%	26.7%

# NJ Population Projections by County, 2010-2030

- Monmouth (#5) and Ocean (#6) are among the top counties with the largest projected population growth.

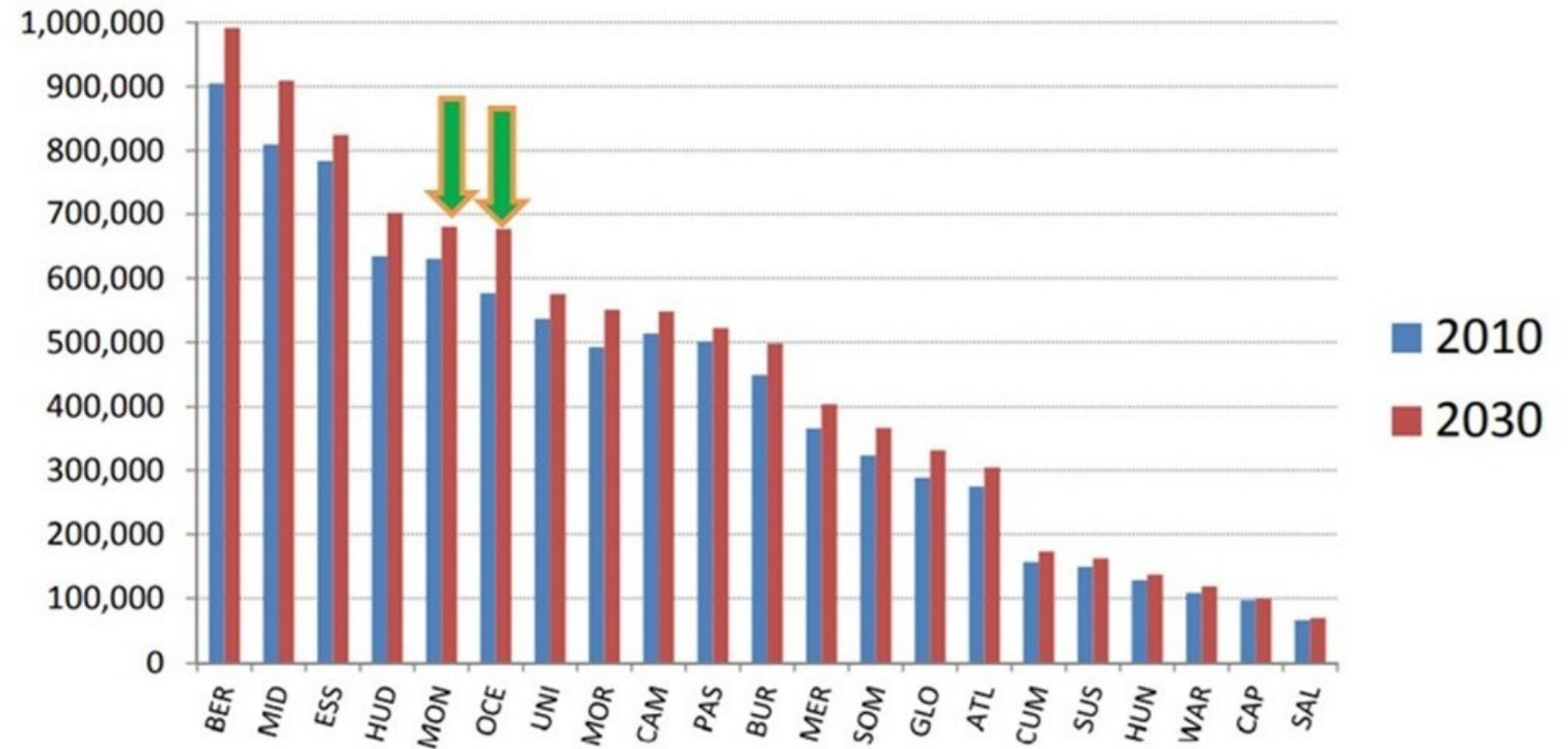

# NJCU @ Brookdale/Wall Moves 11 Miles North to NJCU @ Fort Monmouth

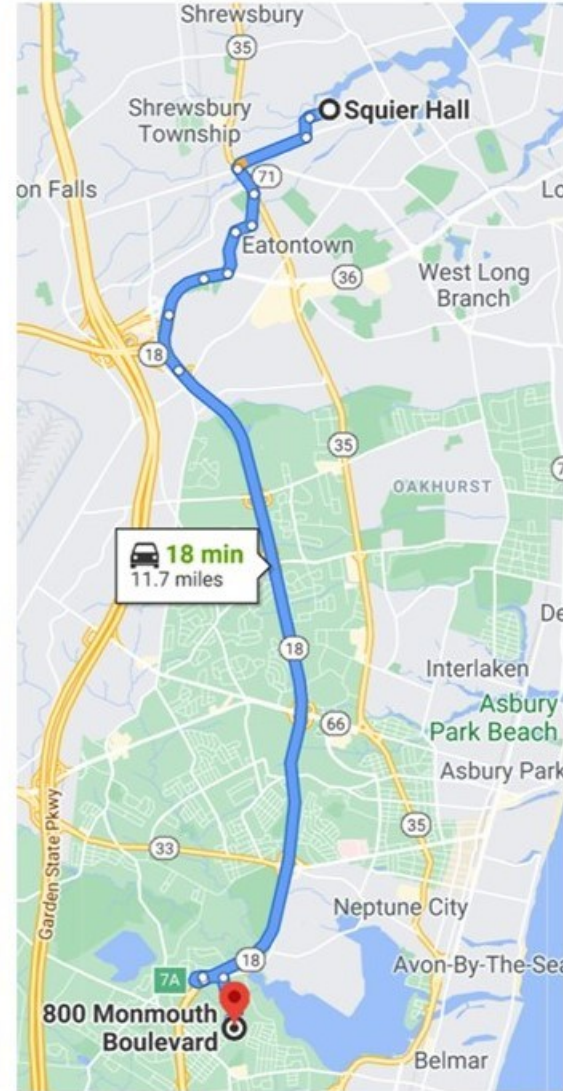

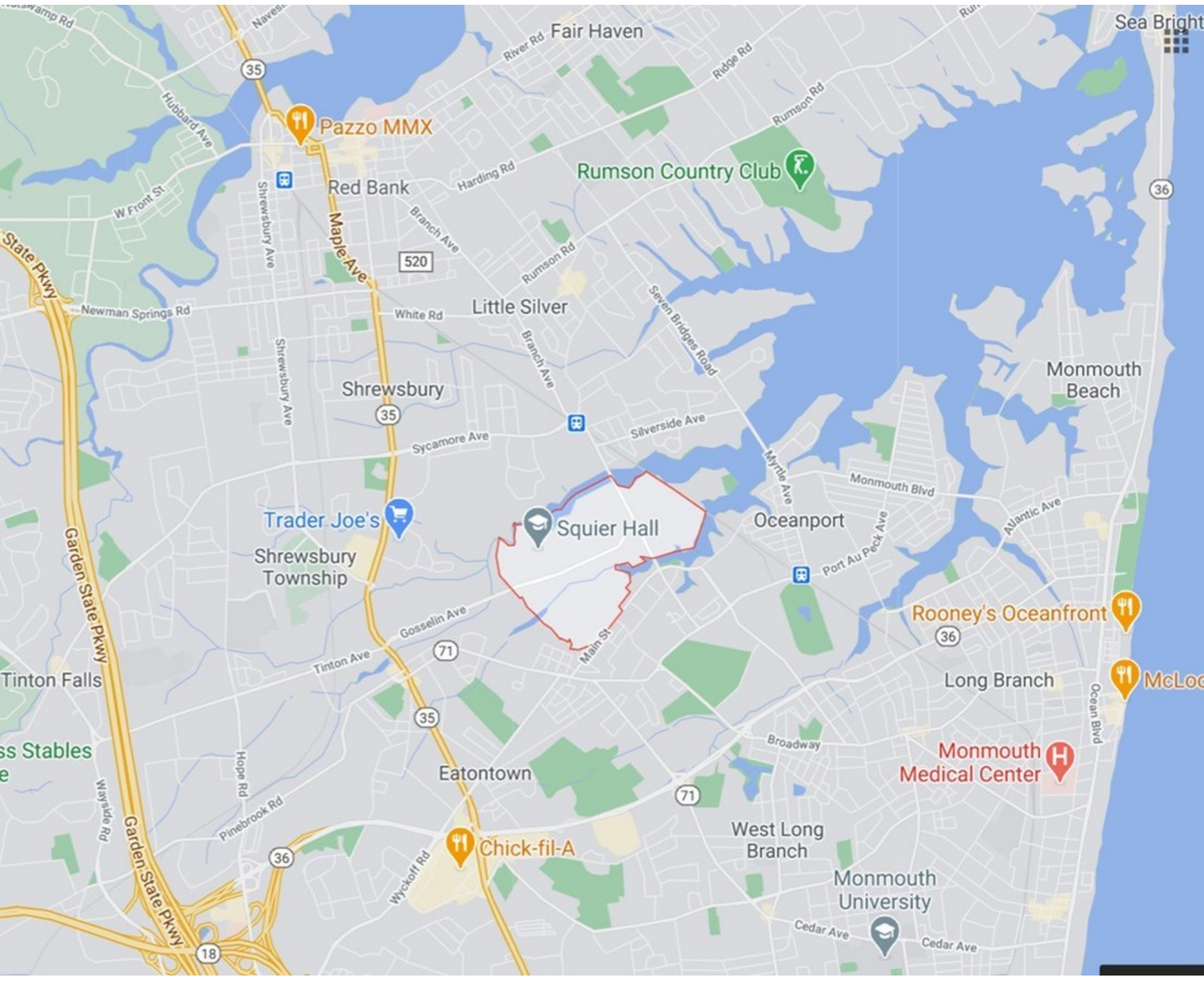

Fort Monmouth,  
located in  
Monmouth  
County is the  
1,126-acre  
former U.S.  
Army base de-  
commissioned in  
2011.

Currently managed by  
Fort  
Monmouth  
Economic  
Revitalization  
Authority  
(FMERA)

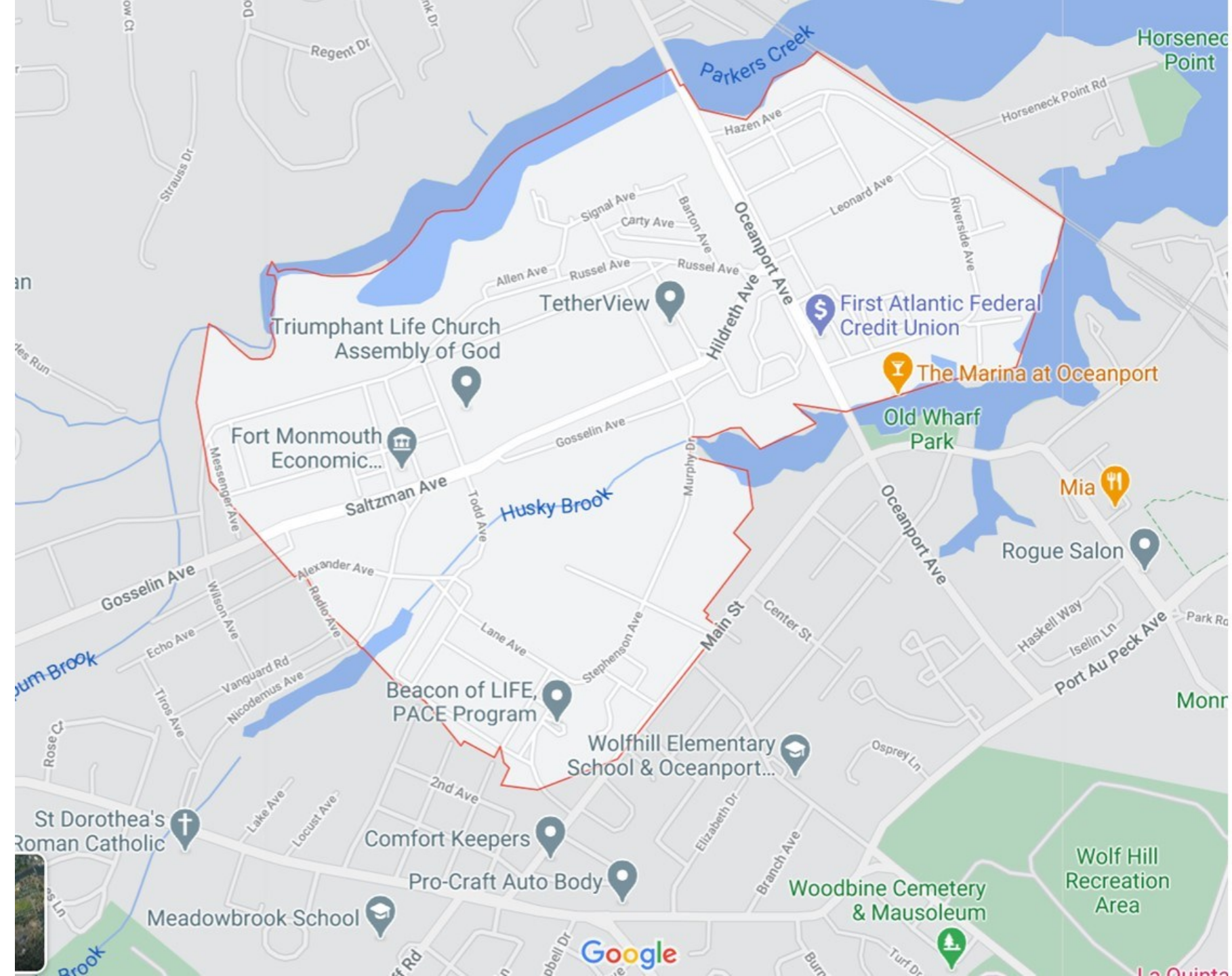

# Transforming Squier Hall For NJCU @ Fort Monmouth



Façade illustration subject to change

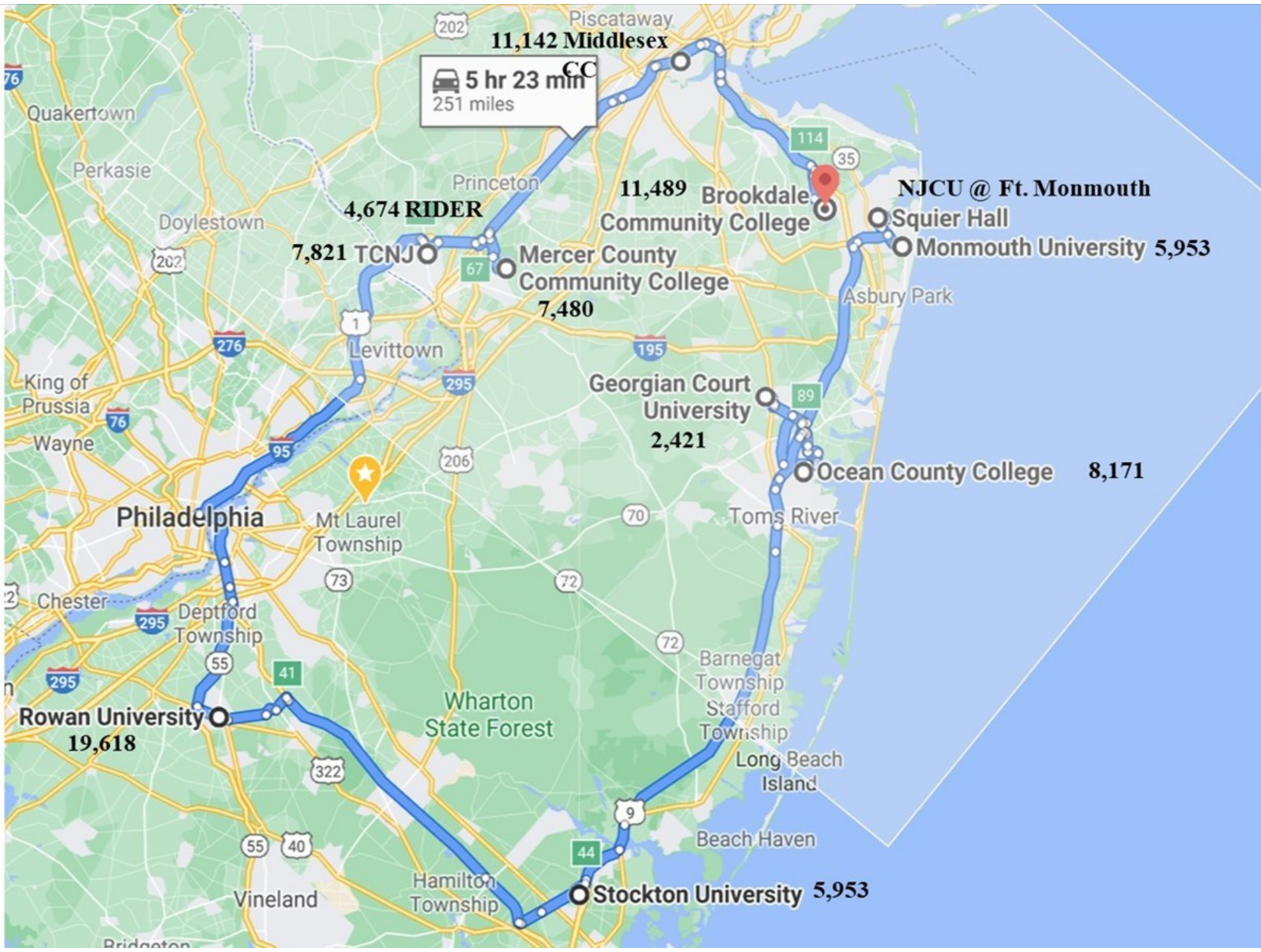

Over 64,000 students attend the 8 institutions in the Monmouth competitive set; with Stockton and Rowan adding another potential 24,000 students in the mix.

## NJCU @ Ft. Monmouth

72,000 square feet

46,000 first floor

26,000 second floor

15 classrooms @ 30 each (~450 total)

Banquet room (~ 120 people)

Nursing Lab

Cyber Security Lab

Bloomberg Trading Terminal

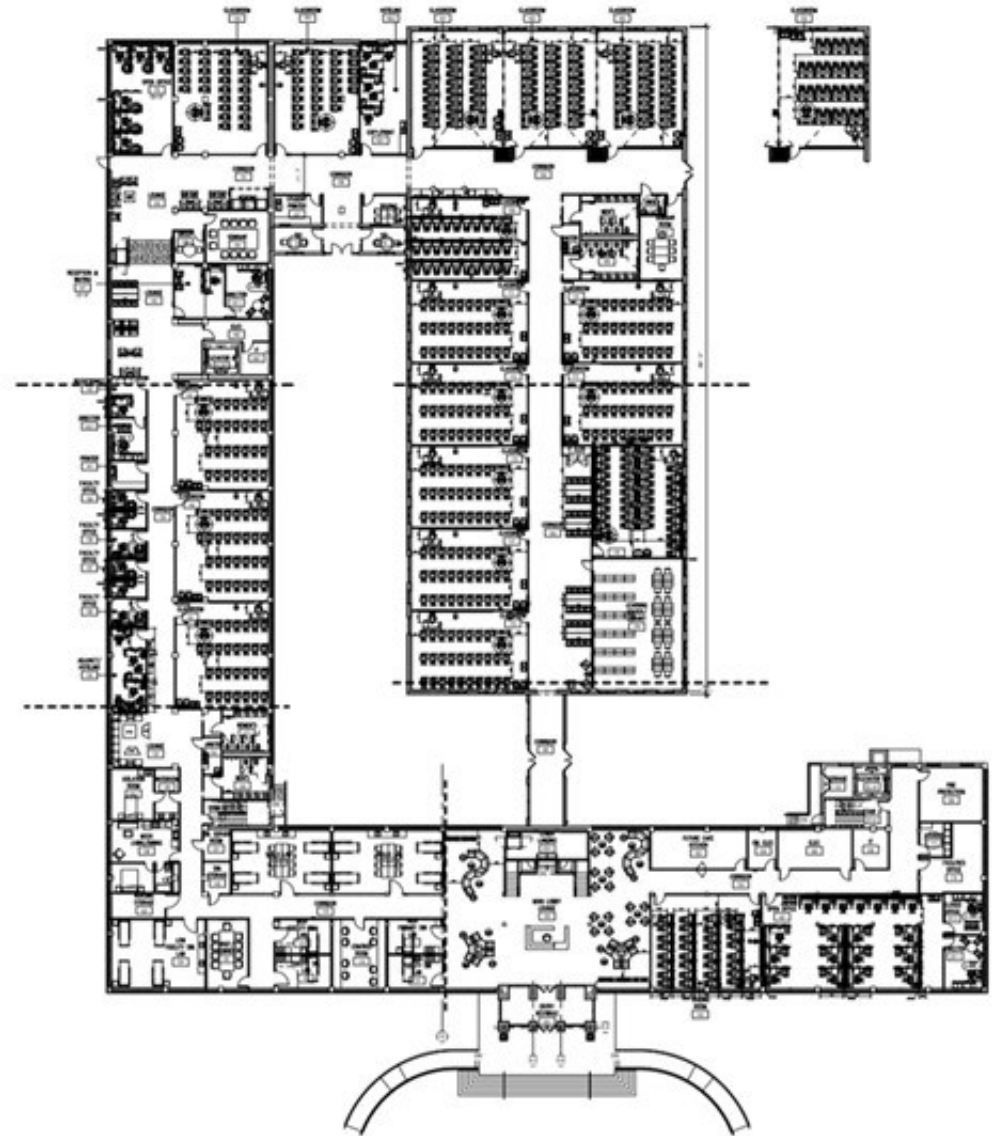



# NJCU @ Ft. Monmouth - Built To Serve Our Students

## *One-Stop Area*

- Advising, Financial Aid, Counseling, Admissions, etc.

## *Facilities*

- Lactation room
- Gender neutral bathroom
- Café/vending machines
- Ample lounge areas
- Large quiet study room
- Faculty lounge
- Faculty hoteling space
- Free parking
- Security



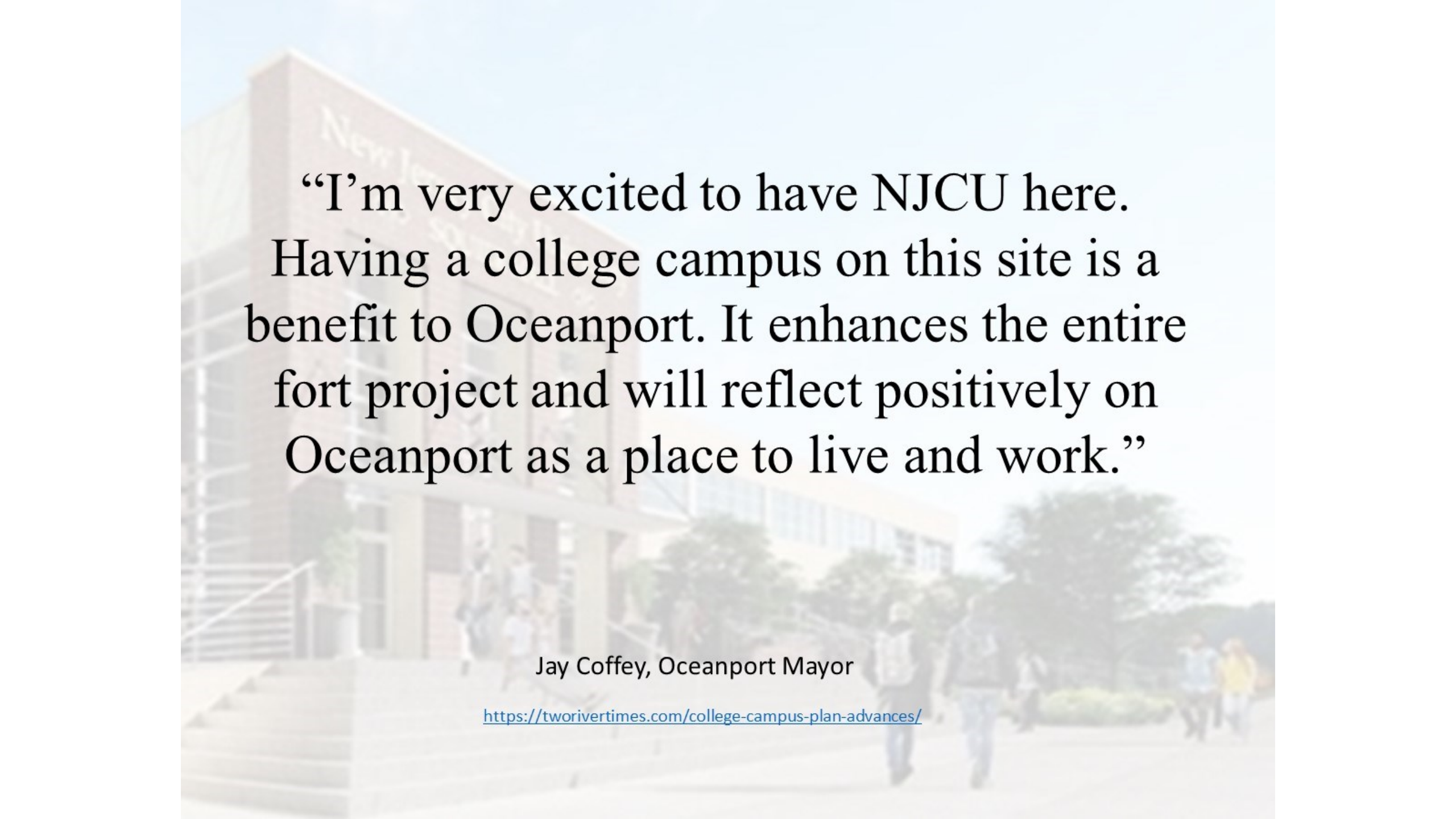

“I’m very excited to have NJCU here. Having a college campus on this site is a benefit to Oceanport. It enhances the entire fort project and will reflect positively on Oceanport as a place to live and work.”

Jay Coffey, Oceanport Mayor

<https://tworivertimes.com/college-campus-plan-advances/>

# Fort Monmouth Financial Forecast

*Draft and Subject to Change*

	FY2021	FY2022	FY2023	FY2024 to FY2025
<b>Revenues (in 000s)</b>				
Existing Students	\$3,595	\$3,680	\$3,767	\$7,802
New Students	\$0	\$1,669	\$2,479	\$8,398
Discounts	(\$853)	(\$1,070)	(\$1,249)	(\$3,240)
<b>Total Net Revenue</b>	<b>\$2,742</b>	<b>\$4,279</b>	<b>\$4,997</b>	<b>\$12,960</b>
<b>Expenses (in 000s)</b>				
Current Lease	\$300	\$0	\$0	\$0
New Lease & Taxes	\$0	\$1,992	\$1,992	\$3,984
Faculty	\$854	\$1,049	\$1,233	\$3,221
Admin, O& M	\$230	\$2,041	\$2,030	\$4,174
<b>Total Expenses</b>	<b>\$1,384</b>	<b>\$5,082</b>	<b>\$5,255</b>	<b>\$11,379</b>
<b>Income/Loss</b>	<b>\$1,358</b>	<b>(\$803)</b>	<b>(\$258)</b>	<b>\$1,581</b>

	FY2021	FY2022	FY2023	FY24 to FY25
<b>Total Enrollment</b>	<b>400</b>	<b>512</b>	<b>596</b>	<b>1,536</b>

Operations and Maintenance includes:

- HVAC/Mechanical
  - Facilities
  - Housekeeping
  - Security
  - IT/Help Desk
  - Maintenance
  - Grounds
- 30-year lease; option to buy after 10 years

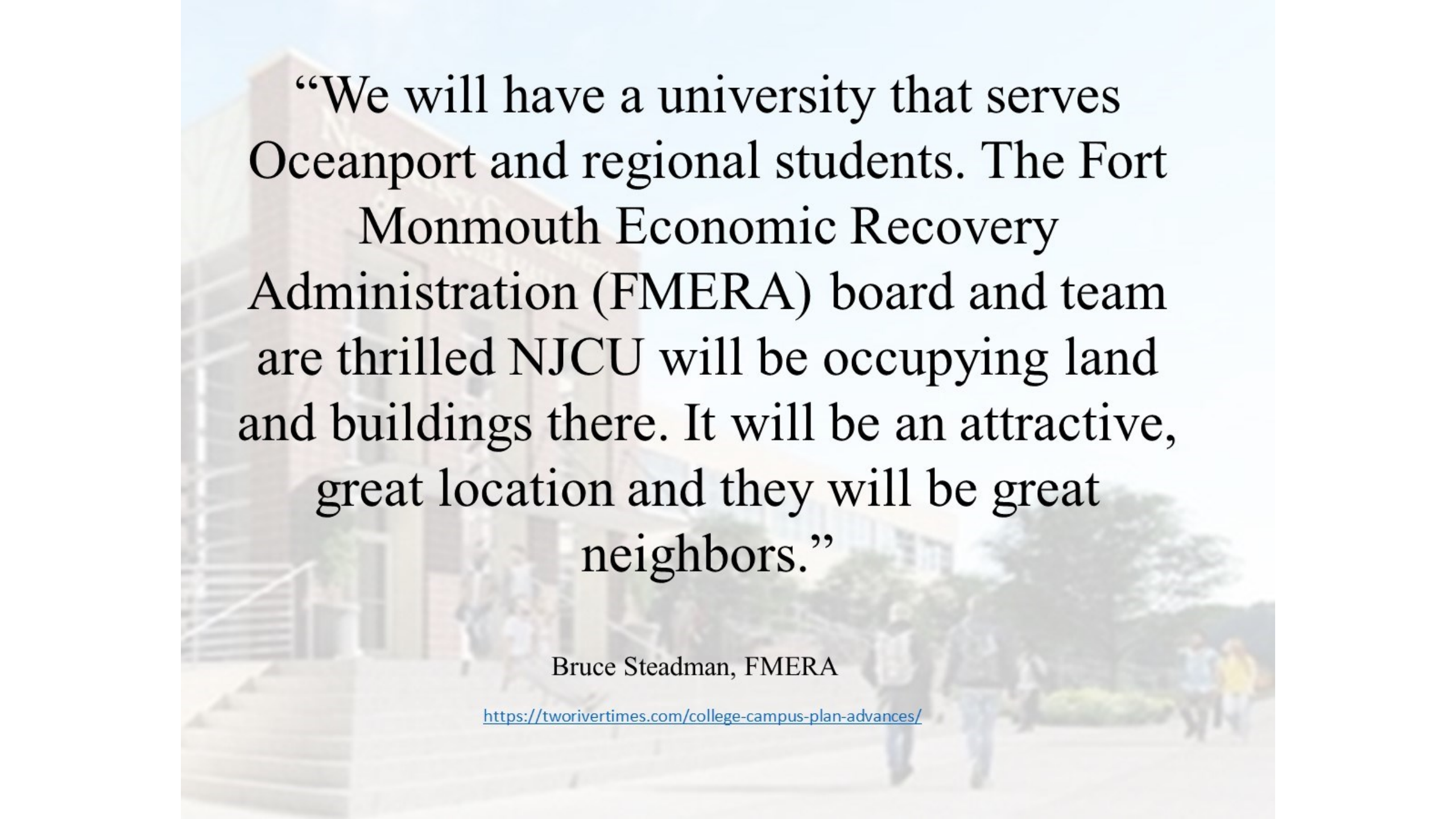

“We will have a university that serves Oceanport and regional students. The Fort Monmouth Economic Recovery Administration (FMERA) board and team are thrilled NJCU will be occupying land and buildings there. It will be an attractive, great location and they will be great neighbors.”

Bruce Steadman, FMERA

<https://tworivertimes.com/college-campus-plan-advances/>

# Fort Monmouth Custom Email

[fortmonmouth@njcu.edu](mailto:fortmonmouth@njcu.edu)

NJCU offers the following academic programs at its Fort Monmouth location.

## Undergraduate Programs

- [Accounting](#)
- [Business Analytics and Data Science](#)
- [Criminal Justice](#)
- [Entrepreneurship](#)
- [Finance](#)
- [Fire Science](#)
- [Global Business](#)
- [Hospitality Management](#)
- [Management](#)
- [Marketing](#)
- [National Security Studies](#)
- [Nursing, Accelerated Program \(2nd degree\)](#)
- [Nursing, R.N. - B.S.N.](#)
- [Sports Management](#)
- [Supply Chain, Logistics, and Maritime Port Management](#)

## Graduate Programs

- [Master of Business Administration:](#)
  - [Specialization in Finance](#)
  - [Specialization in Marketing](#)
  - [Specialization in Organizational Management and Leadership](#)
  - [Customizable MBA](#)
  - [Special Certificate of Readiness \(CORE\) from Harvard Business School Online](#)
- [Accounting](#)
- [Business Analytics and Data Science](#)
- [Finance](#)
  - [Specialization in Financial Management](#)
  - [Specialization in Financial Analysis](#)
  - [Specialization in Risk Management and Compliance](#)
- [Financial Technology](#)
- [Nursing:](#)
  - [Nursing specialization in Nursing Education](#)



[Arts and Sciences >](#)

The William J Maxwell College of Arts & Sciences



[School of Business >](#)

The NJCU School of Business



[College of Education >](#)

The Deborah Cannon Partridge Wolfe College of Education



[College of Professional Studies >](#)

The College of Professional Studies

Subject to change

For information on these or other NJCU academic programs, please email [fortmonmouth@njcu.edu](mailto:fortmonmouth@njcu.edu)

# Fort Monmouth Custom URL

## [www.njcu.edu/fortmonmouth](http://www.njcu.edu/fortmonmouth)



[Webmail](#) [GothicNet](#) [Library](#) [Directories](#)

[Information for](#) ▼

[Visit](#)

[Apply](#)

[Give](#)

[Select Language](#) ▼

[About](#)

[Admissions & Aid](#)

[Academics](#)

[Student Life](#)

[Community](#)



## NJCU at Fort Monmouth



[Home](#) › [Academics](#) › [Schools & Colleges](#) › [Community College Partnerships](#) ›

### Community College Partnerships

#### *NJCU at Fort Monmouth*

[About NJCU at Fort Monmouth](#)

[Academics at Fort Monmouth](#)

[Directions to NJCU at Fort Monmouth](#)

[Fort Monmouth FAQ](#)

## NJCU @ Fort Monmouth – COMING SOON – FALL 2021

The mission at New Jersey City University (NJCU) is to provide a diverse population with an excellent education. The University is committed to the improvement of the educational, intellectual, cultural, socioeconomic, and physical environment of the surrounding urban region and beyond.

*U.S. News and World Report* ranked NJCU as the best public university in New Jersey for ethnic diversity, *Washington Monthly* ranked NJCU #2 in the state for serving students in need, and *the Social Mobility Index* ranked NJCU #72 in the nation for the ability of its alumni to increase their social mobility. NJCU offers 49 undergraduate programs, 27 graduate programs, and three doctoral programs to over 6,500 students.